

136/20 (22.88.81)

C PERKIN LTD Shaw Cross Dewsbury England		Machine CL2	
Part Bottom glue roller		Loc. Gluer	
No off 1		Scale 1:2	
DWG No		Date May 98	
136/20		LV 223	

Material: Stainless steel  
Finish grind on centres

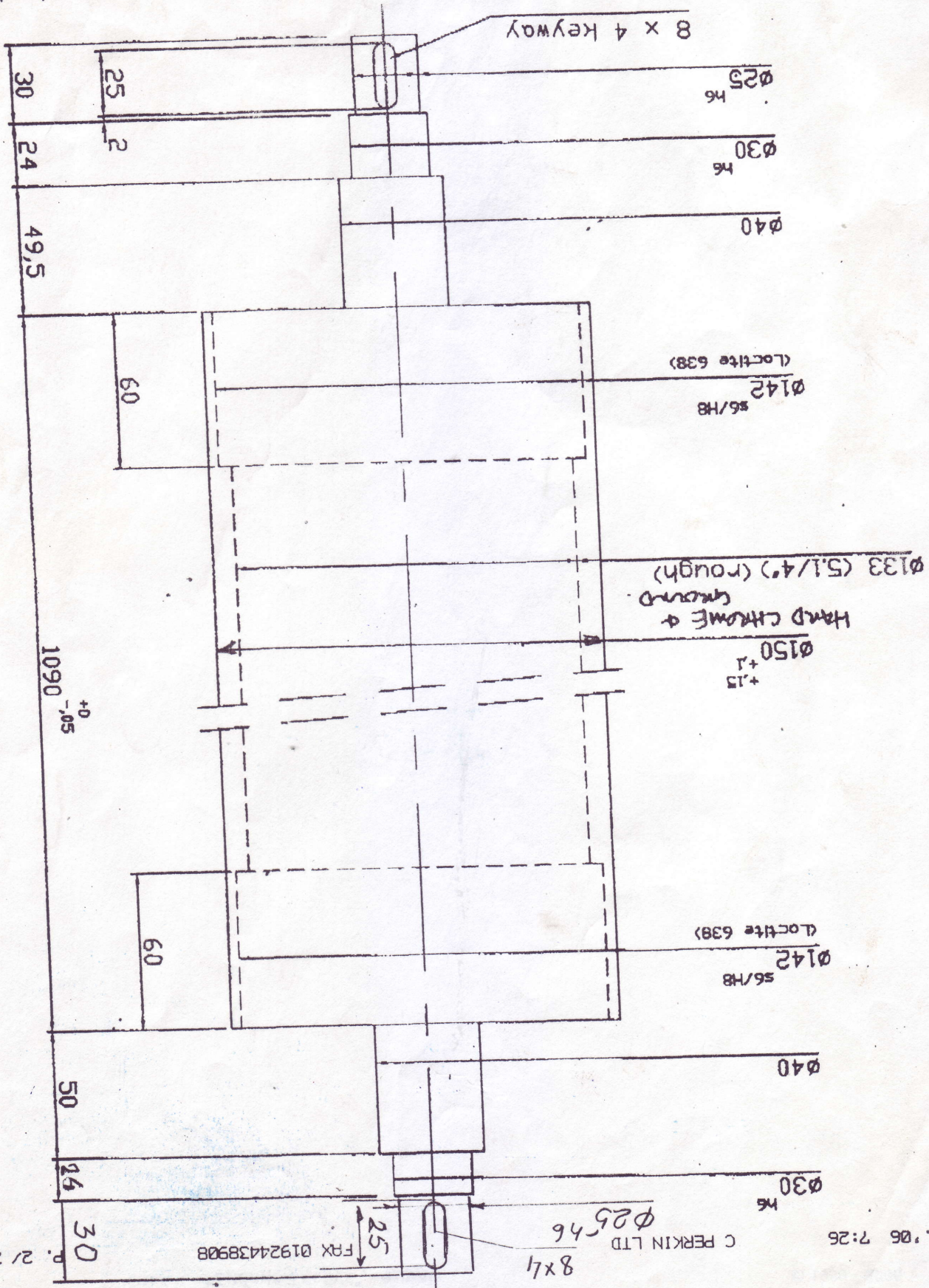

15 Aug. '06 7:26

C PERKIN LTD  
FRX 01924438908

P. 2/2

2. Wagonbe 000 pp-1m 13714

г. Иваново ООО ф-ма ИТУ  
 Г.И.И.И. Александровский Павел Степанович

15 Aug. '06 7:26

C PERKIN LTD

FAX 01924438908

P. 1/2

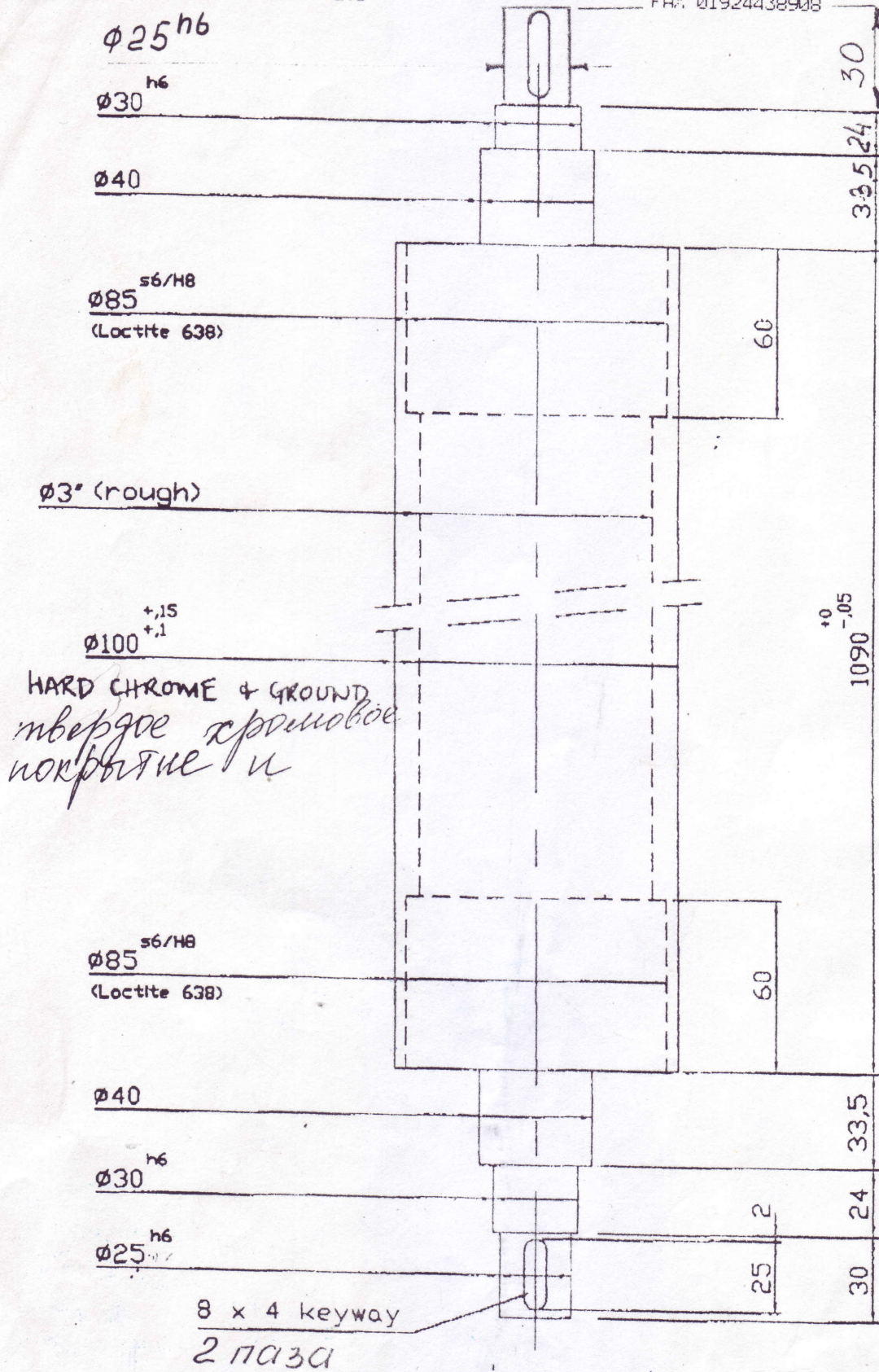

ТЕН.  
 104

HARD CHROME + GROUND  
 твёрдое хромированное  
 покрытие и

C.PERKIN Ltd Shaw Cross Dewsbury England	#05v092, #3'v0 3.1/4', 1090v990, #100v crowned b4 Gcan Apr 04	Part Top glue roller	136/20	DWG No LW 222
		Loc <sup>n</sup> Gluer	No off 1	
		Machine CL2	Matl	
			Scale 1:2	
			Date May 98	